

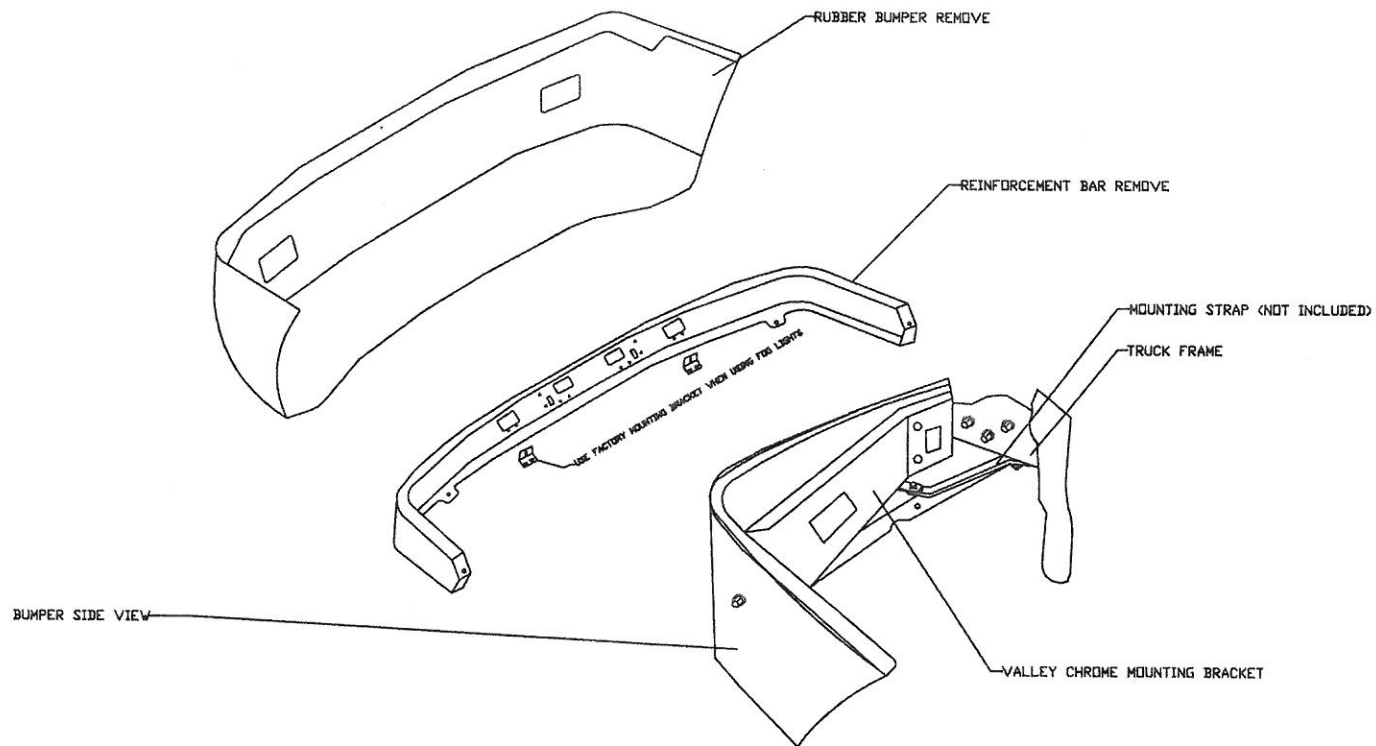

PLEASE NOTE BOLTS IN BRACKETS
ARE USED FOR SHIPPING ONLY!!!
YOU MUST SUPPLY YOUR OWN MOUNTING BOLTS.

CI MOUNTING INSTRUCTIONS



1. Mount brackets to bumper and tighten.
2. Mount bumper to frame of truck attach mounting strap to bracket (do not tighten).
3. Adjust bumper to fit truck and tighten bolts.
4. DO NOT USE IMPACT WRENCH TO TIGHTEN BOLTS ON FACE OF BUMPER.
5. All four mounting bolts must be used, and mounting straps.